

Barry Stoodley Pty Ltd



COUPLINGS

Rigid Mount Bolt-On Drawbar (4 Bolt Mounting Base/Plate Mount)

Forged alloy steel and heat treated throughout for toughness, strength, and durable operation. Used on trailers, semitrailers (including doubles), and equipment designed for on- and off-road towing applications within the stated capacities. Tested in accordance with SAE J847 (Type II).

NOTE 1: Not designed to be welded to a trailer tongue.

NOTE 2: For off-road applications, reduce the stated capacities by 25% and use with a swivel-mount coupling device.

The bolt pattern is the same as the previous DB1385 model but uses 20mm bolts.

Weighs less than the competition.

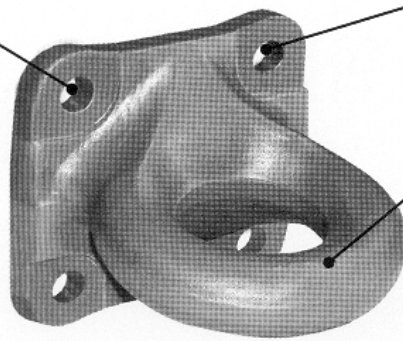

The bolt head area is strengthened for greater strength and durability than similar products.

The drawbar eye is 76.2mm I.D. with a 41.4mm diameter cross section. It is induction hardened in the pintle hook contact area for increased strength and wear resistance.

Additionally tested in accordance with ADR 62/01.

Part Number	Length	Weight	Maximum Vertical Load	Maximum Gross Trailer Weight	D-Rating kN	CRN Number
DB1385	173.4 mm	8.6 kg	6,804 kg	27,216 kg	165 kN	24296

IMPORTANT: When used with hinged tongue trailers, where the maximum vertical load cannot exceed 227kg (500 lbs,) the maximum gross trailer weight is 40,824 kg (90,000 lbs.).

Rigid Mount Bolt-On Drawbar (4 Bolt Mounting Base/Plate Mount) Replaces DB125015

The bolt pattern is the same as Holland model DB-1250-15.

Ultra-light weight with superior strength!

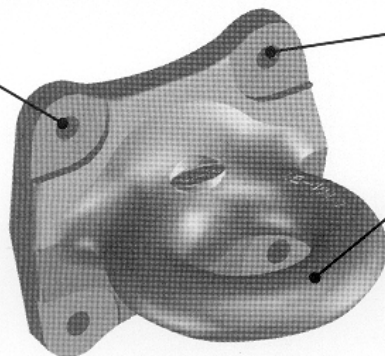

The bolt head area is strengthened for more durability than similar products.

For maximum durability and minimum wear, the drawbar eye has a 63.5mm I.D. with a 31.75mm x 38.1mm diameter section to match a pintle horn or coupler jaw.

Part Number	Length	Weight	Maximum Vertical Load	Maximum Gross Trailer Weight	D-Rating kN	CRN Number
DB040DQ1	155.7 mm	6.3 kg	3,629 kg	18,144 kg	N/A	N/A

IMPORTANT: When used with hinged tongue trailers, where the maximum vertical load cannot exceed 227kg (500 lbs,) the maximum gross trailer weight is 27,216 kg (60,000 lbs.).

NOTE: Specifications regarding measurements and weights are nominal only. We reserve the right to make changes as necessary.

Barry Stoodley Pty Ltd



COUPLINGS

Swivel Mount Weld-On Drawbar

GO THE DISTANCE.

Forged alloy steel and heat treated throughout for toughness, strength, and durable operation. Used on straight tongue trailers, semitrailers (including doubles), and equipment designed for on- and off-road towing applications within the stated capacities.

NOTE 1: This drawbar must be used only in conjunction with a rigid mount coupling device.

NOTE 2: For off-road applications, reduce the stated capacities by 25%.

The shank mount is easy to replace and offers compact installation.

Drawbar includes a washer, nut, cotter pin, and the assembly includes a zerk fitting for easy lubrication.

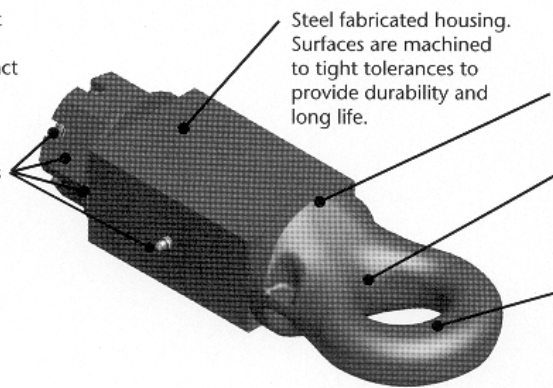

Steel fabricated housing. Surfaces are machined to tight tolerances to provide durability and long life.

50mm O.D. shank.

The drawbar eye is 60.4mm I.D. with a 41.4mm diameter cross section.

The drawbar eye is induction hardened in the pintle hook contact area for increased wear resistance and durable service.

Part Number	Length	Weight	Maximum Vertical Load	Maximum Gross Trailer Weight	D-Rating kN	CRN Number
DB045BW1	381 mm	17.3 kg	4,082 kg	20,412 kg	N/A	N/A

IMPORTANT: When used with hinged tongue trailers, where the maximum vertical load cannot exceed 227kg (500 lbs,) the maximum gross trailer weight is 38,556 kg (85,000 lbs.).

Swivel Mount Weld-On Drawbar

The shank mount is easy to replace and offers compact installation.

Drawbar includes a washer, nut, cotter pin, and the assembly includes a zerk fitting for easy lubrication.

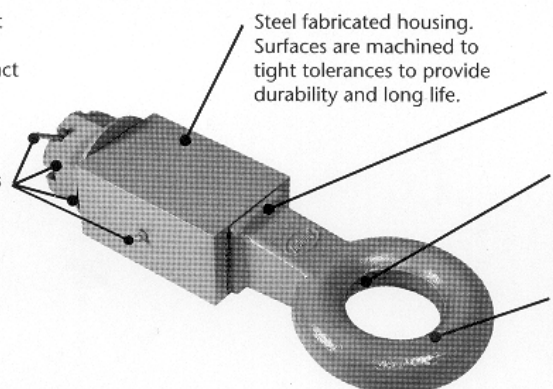

Steel fabricated housing. Surfaces are machined to tight tolerances to provide durability and long life.

50mm O.D. shank.

The drawbar eye is 76.1mm I.D. with a 41.4mm diameter cross section.

The drawbar eye is induction hardened in the pintle hook contact area for increased wear resistance and durable service.

Part Number	Length	Weight	Maximum Vertical Load	Maximum Gross Trailer Weight	D-Rating kN	CRN Number
DB61030S	434.9 mm	16.3 kg	4,082 kg	20,412 kg	N/A	N/A

IMPORTANT: When used with hinged tongue trailers, where the maximum vertical load cannot exceed 227kg (500 lbs,) the maximum gross trailer weight is 38,556 kg (85,000 lbs.).

NOTE: Specifications regarding measurements and weights are nominal only. We reserve the right to make changes as necessary.

Barry Stoodley Pty Ltd

DRAWBAR EYES

A
8
0
0

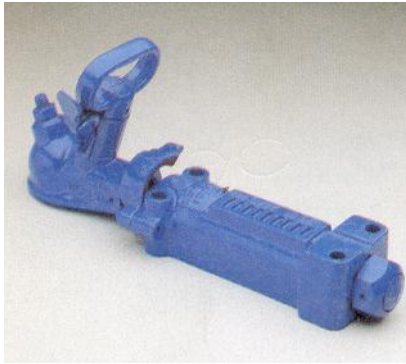

50mm Override Coupling Body
Heavy duty 38mm S1040 shaft
Domed shaft for smoother braking
Padlocking facility for security
Grease nipples fitted for servicing
All ductile castings
Reversing lock facility

A
7
9
5



75mm Ring override coupling
ADR rating 6 tonne
High strength ductile iron
40mm ring section

A
7
9
0



75mm Ring override coupling
ADR rating 2.25 tonne
360 degree rotation
High strength S1040 shaft
Reversing clamp fitted
All ductile castings 40mm ring section

A
7
6
0



75mm Ring override coupling
ADR rating 3 tonne
High strength ductile iron
40mm ring section

Barry Stoodley Pty Ltd

WILLEX TOWEYES

WE11001

Swivel Towing Eye
76mm X 41mm (ADR62)
12 Tonne 'D' Rating

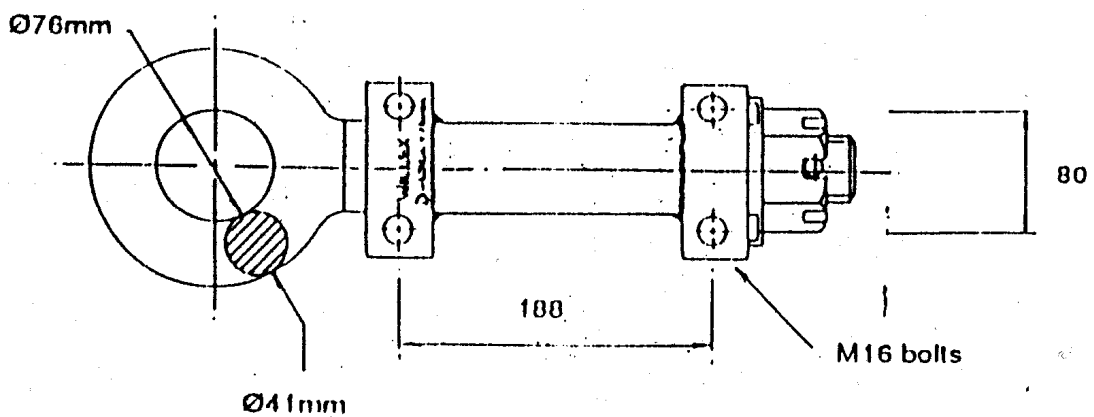

WE11002

Swivel Towing Eye
76mm X 41mm (ADR62)
10 Tonne 'D' Rating

